

Pratt Burnerd International 3 Jaw Griptru Scroll Chucks

Often used in grinding operations, these chucks allow the operator to re-align the front body of the chuck and therefore the workpiece in relation to the spindle nose, thus giving increased accuracy of within 0.005mm. The chuck will then grip subsequent workpieces of the same diameter within 0.013mm. Griptru chucks can be used as normal chucks, simply by leaving the front body in the central position.

Exceeds ISO 3089: 1991 (E) Class I

- Micro adjustment feature allows chuck to be trued to within 0.005mm
- Repeatability 0.013mm on same size component
- Sizes 80mm to 315mm
- Three hardened pinions
- Complete with one set of each hard inside and hard outside jaws
- High strength nodular iron bodies
- Twelve month warranty

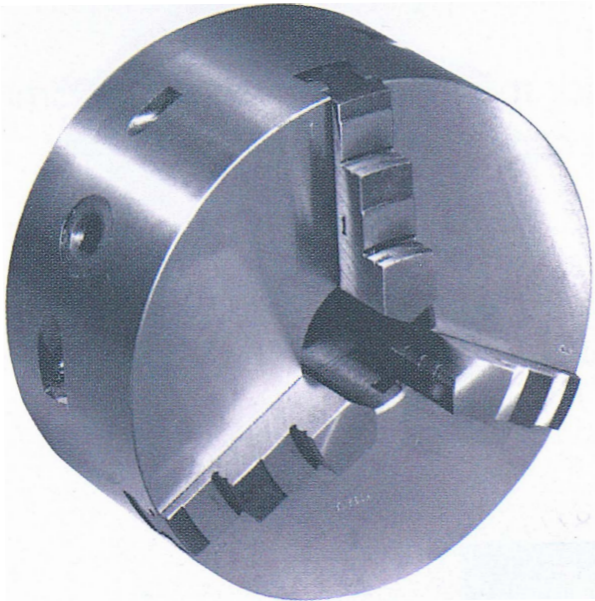

These chucks require special adaptors, please contact the factory for details. **We supply soft blank jaws for all above models please ask for details.**

Chuck Size	Model Number	Approx. Weight (kilos)	Maximum RPM
80mm	9250-00805	2	5000
100mm	9250-01005	3.1	5000
125mm	9250-01305	5.4	5000
160mm	9250-01705	9.6	5000
200mm	9250-02005	16.8	4900
250mm	9250-02505	31.7	4200
315mm	9250-03205	47.4	3300

Dimensional Data for 3 jaw Griptru Scroll Chucks

Chuck Size								Gripping Capacity	
(A)	B(H7)	C	D	E	F	G	K	Min	Max
80	63.5	19	54	14	12	71.3	M5	1	76
100	76.2	25.4	56.6	17	12	88.9	M6	1	98
125	95	35	69	19	15	107.9	M8	1.5	124
160	125	45.9	78.6	23	20	139.9	M10	1.5	160
200	160	54.8	89.8	29	22	176	M10	2	200
250	200	75.9	101.3	33	25	224	M12	3	250
315	260	102.8	110	40	25	286	M12	6	304

Pratt Burnerd International 6 Jaw Griptru Scroll Chucks

Chucks with 6 jaws are used to reduce distortion in thin walled components, or to spread the gripping force more evenly, giving a better finish in grinding operations. These chucks allow the operator to re-align the front body of the chuck and therefore the workpiece in relation to the spindle nose, thus giving increased accuracy of within 0.005mm. The chuck will then grip subsequent workpieces of the same diameter within 0.013mm. Griptru chucks can be used as normal chucks, simply by leaving the front body in the central position.

Exceeds ISO 3089: 1991 (E) Class I

- Micro adjustment feature allows chuck to be trued to within 0.005mm
- Repeatability 0.013mm on same size component
- Sizes 125mm to 315mm
- Three hardened pinions
- Complete with one set of each hard inside and hard outside jaws
- High strength nodular iron bodies
- Twelve month warranty

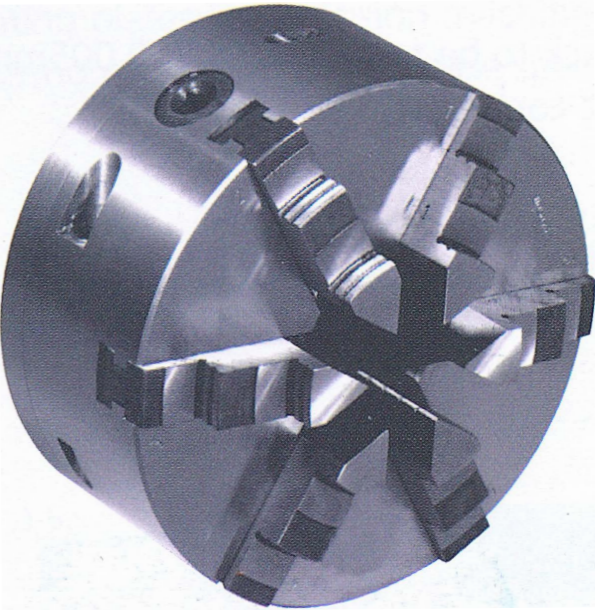

These chucks require special adaptors, please contact the factory for details. **We supply soft blank jaws for all above models please ask for details.**

Chuck Size	Model Number	Approx. Weight (kilos)	Maximum RPM
125mm	9260-01305	6.2	5000
160mm	9260-01705	11	4900
200mm	9260-02005	18.9	4200
250mm	9260-02505	36.7	3300
315mm	9260-03205	53.4	2700

Dimensional Data for 6 jaw Griptru scroll Chucks

Chuck Size								Gripping Capacity	
(A)	B(H7)	C	D	E	F	G	K	Min	Max
125	95	35	69	19	15	107.9	M8	1.5	124
160	125	45.9	78.6	23	20	139.9	M10	1.5	160
200	160	54.8	89.8	29	22	176	M10	2	200
250	200	75.9	101.3	33	25	224	M12	3	250
315	260	102.8	110	40	25	286	M12	6	304